

°eluma application specifications

for additional information or customer support please contact your distributor

Exit Wire Options (choose one)

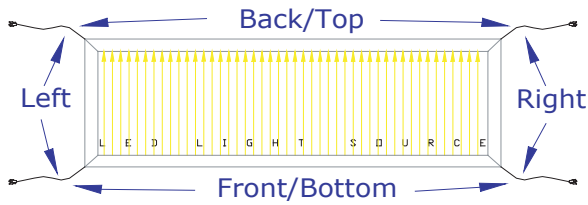

Choose exit wire location (must be a corner)

Specify exit wire (pigtail) length: Std.3", *Max.20"

*Back/Top wire exit (opposite LEDs), subtract shelf/panel depth dimension from 20" maximum available wire exit length.
(Example: 12" shelf/panel depth will have 8" available wire exit length)

Fixed Shelving (Direct Wiring: **OPTION A**)

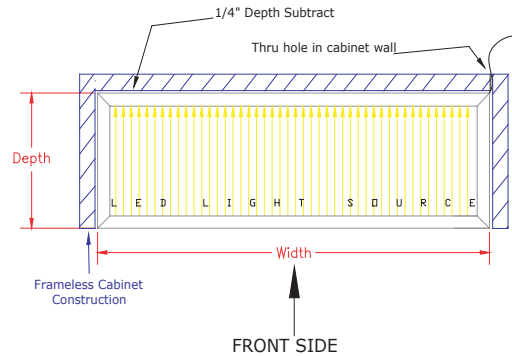

Adjustable Shelving (**OPTION B**)

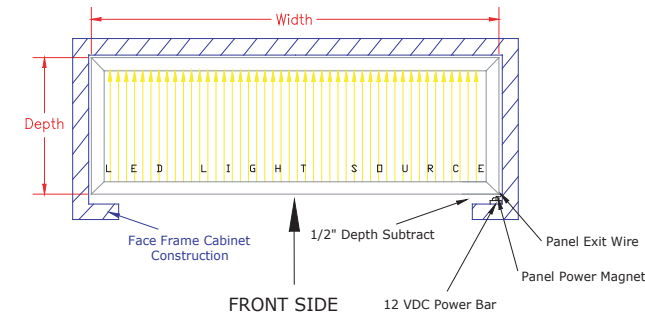

Backsplash Panel (Direct Wiring: **OPTION A**)

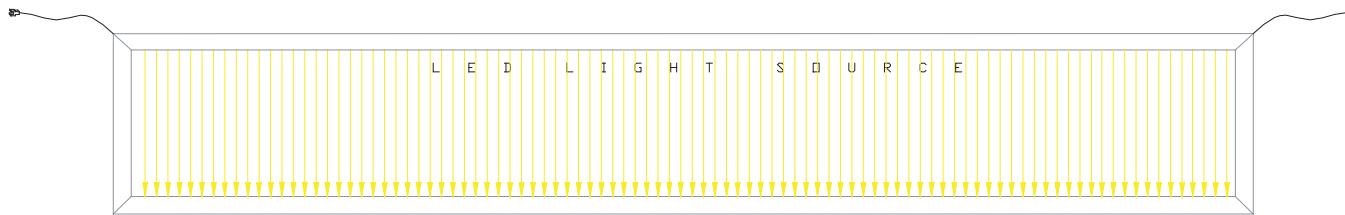

If overall backsplash width/length is greater than 60", two exit wires are required on the illuminated backsplash.

White backsplash acrylic backer panel included to eliminate transparency through illuminated backsplash.

Attachment of backsplash to wall is the responsibility of the installer.
(recommended backsplash installation methods are mounting bracket, screw to wall, or adhesive)

Wall Mount Shelving (**OPTION A or B**)

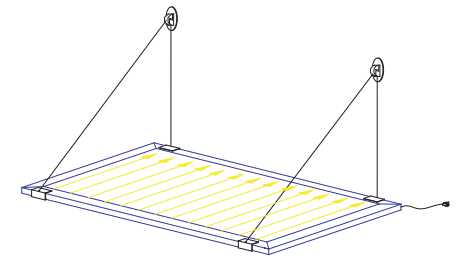

Wall Mount Shelving can be direct wire or adjustable.

Electrical Components

°eluma Panel

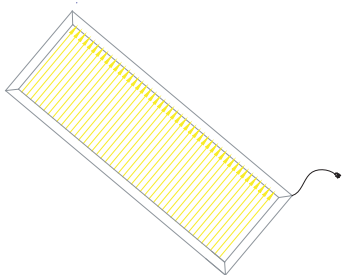

(REQUIRED)

+

Fixed Shelf/
Panel Components:
(**OPTION A**)

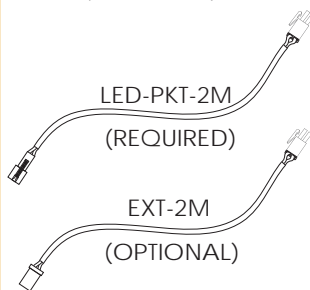

OR

Adjustable Shelf/
Panel Components:
(**OPTION B**)

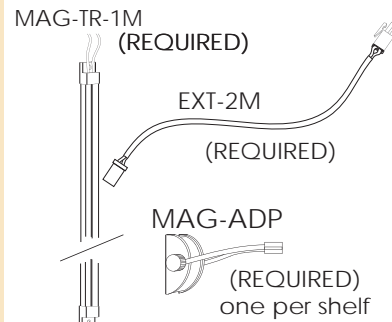

+

On-Off Switch Components:
(**OPTIONAL - CHOOSE 1**)

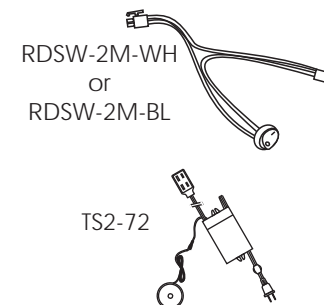

+

Power Components:
(**REQUIRED - CHOOSE 1**)

